



DISCLAIMER

This document or some parts of it may not be accessible when using adaptive technology.

If you require assistance with accessing the content of the document, please contact the Planning team and quote the document name and the web page you found it on:

- email: planning.admin@ashfield.gov.uk
- telephone: 01623 457 388

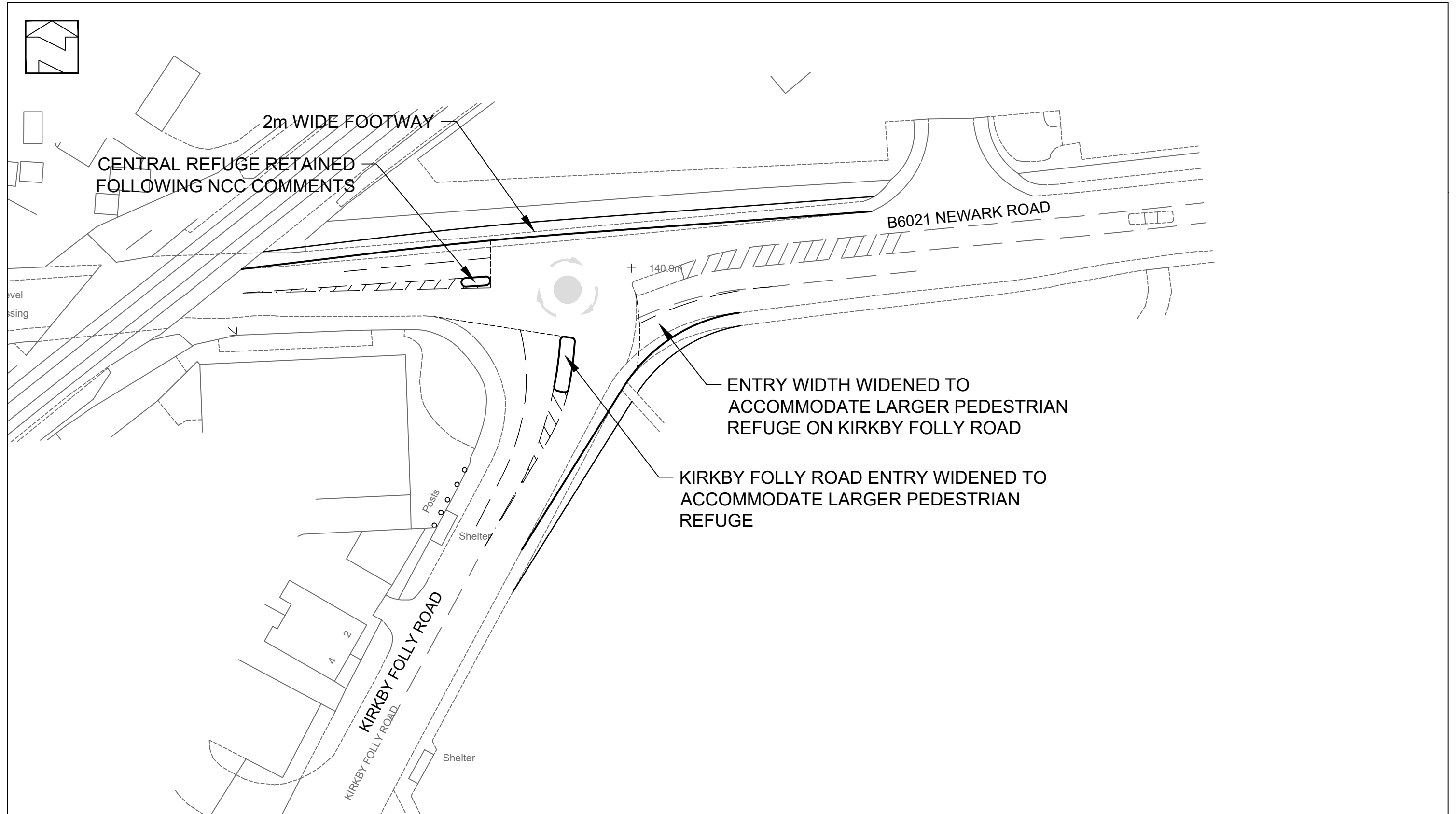

			Project: Proposed Residential Development Newark Road, Sutton in Ashfield	Client: Hallam Land Management	<div><div>ADC</div><div>INFRASTRUCTURE</div></div>			
P8	Revised layout following NCC comments	01/04/19						
P7	Revised to accommodate HGVs	12/02/19						
P6	Revised layout following comments	31/01/19						
P5	Revised layout following comments	30/08/18	Title: Proposed Improvement Scheme Newark Road / Kirkby Folly Road		Drg Size:	Scale:	Date:	
P4	Revised layout following RSA comments	02/05/18			A3	1:500	15/06/2017	
P3	Revised Junction Layout	11/04/18			Drg No:			Rev:
Rev	Description	Date			ADC1580-DR-004			P8